

Overview

How does the WIFI module look like

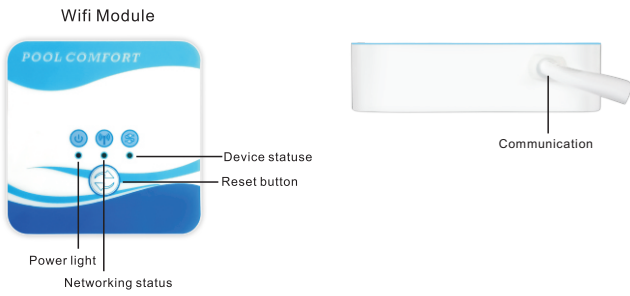

Learn the dimension of WIFI module

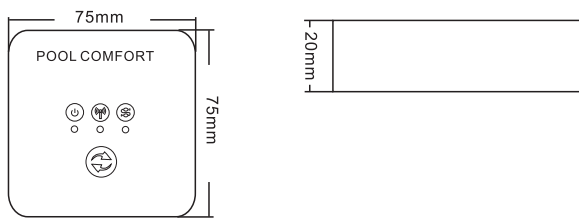

1

Quick Start

Step 1

Search for "U-SPA" in the Apple APP Store or Google Play, download and install.

Step 2

Set up an account using your mobile phone number or email address.

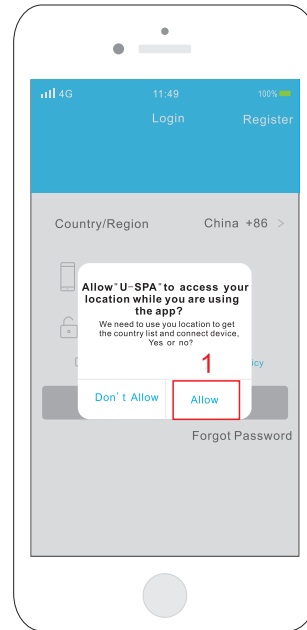

1. Click allow.

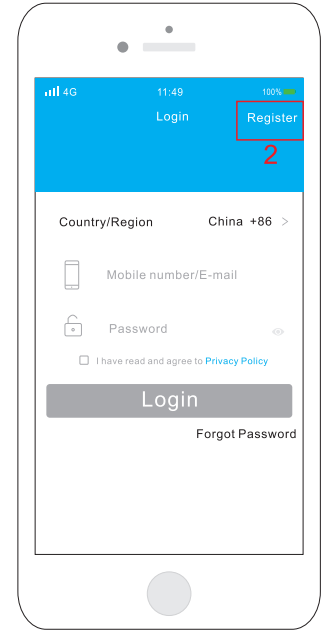

2. Click register.

2

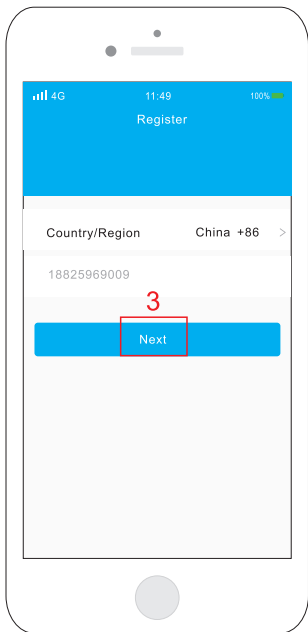

3. Select country/region, enter mobile phone number or email address, then click Next.

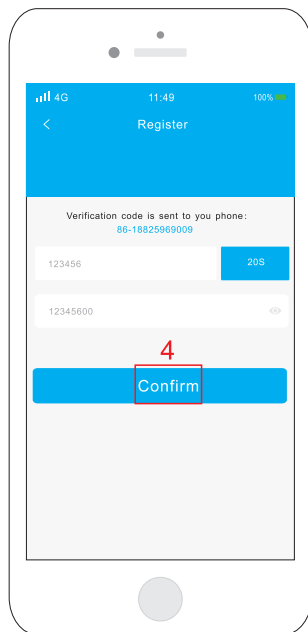

4. Enter the verification code and password, and click Confirm. Then the account is created successfully.

3

Step 3

Login your account, select Add device. Make sure your phone is connected to WiFi and has accessed to Internet.

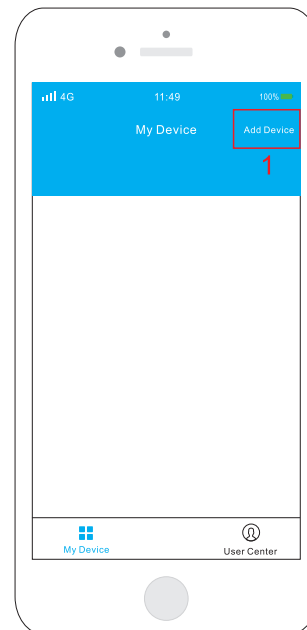

1. Click Add device.

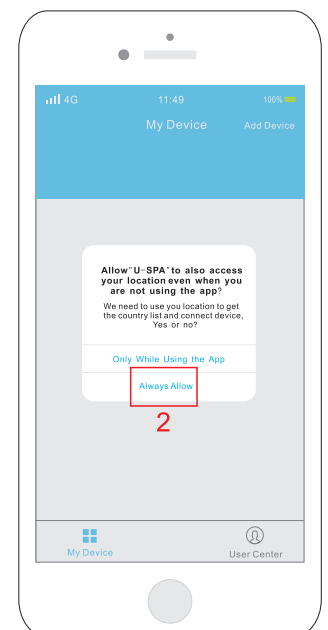

2. Click Always Allow.

4



3. Click CONNECT DEVICE.

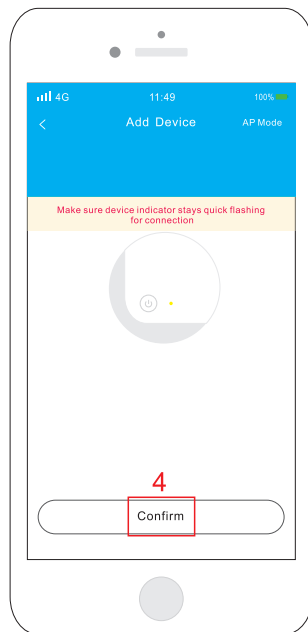

4. Make sure device indicator stays quick flashing for connection, then click confirm.

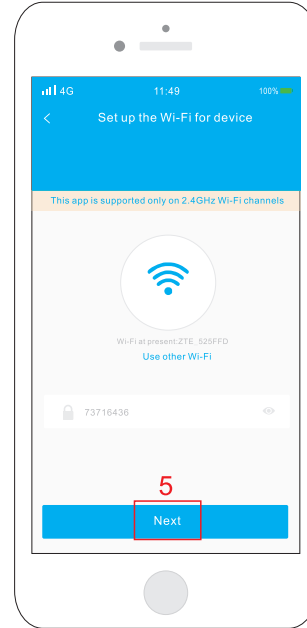

5. The system will automatically obtain the WiFi name connected to the mobile phone, enter the WiFi password, and click Next.

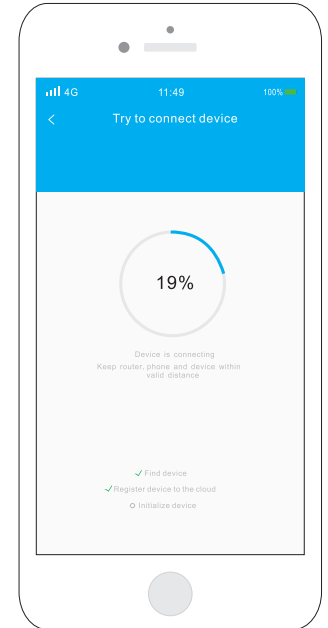

6. Please make sure the WIFI module, your cell phone and router are closer enough.

5

6

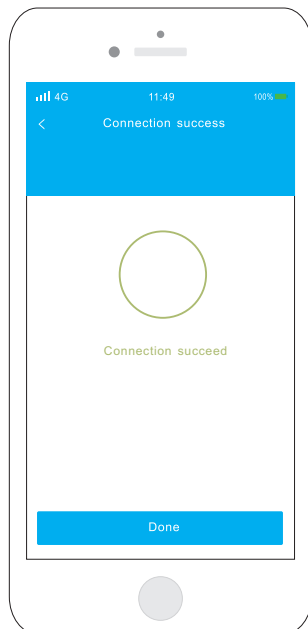

7. Congratulations! The device is connected.

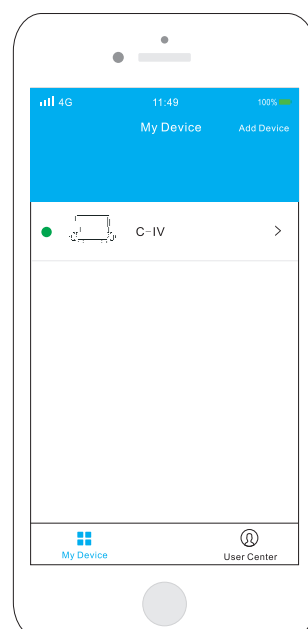

Step 4

Change the device name or account password.

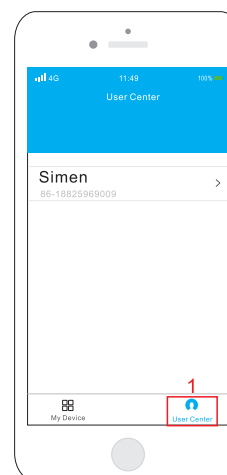

1. Click User Center.

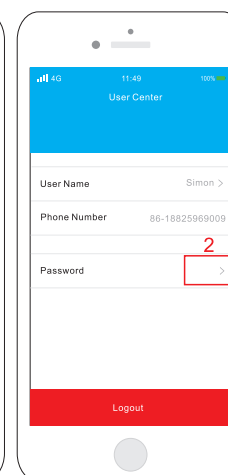

2. Click the user name to change the device name as you wish. Click Password to change the login password and keep it safely.

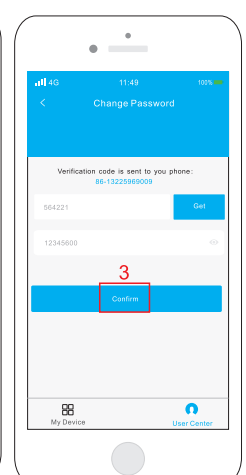

3. Enter the verification code and the new password, then click Confirm to set your new password.

7

8

Home page

You can check SPA status and water temperature on the main screen.

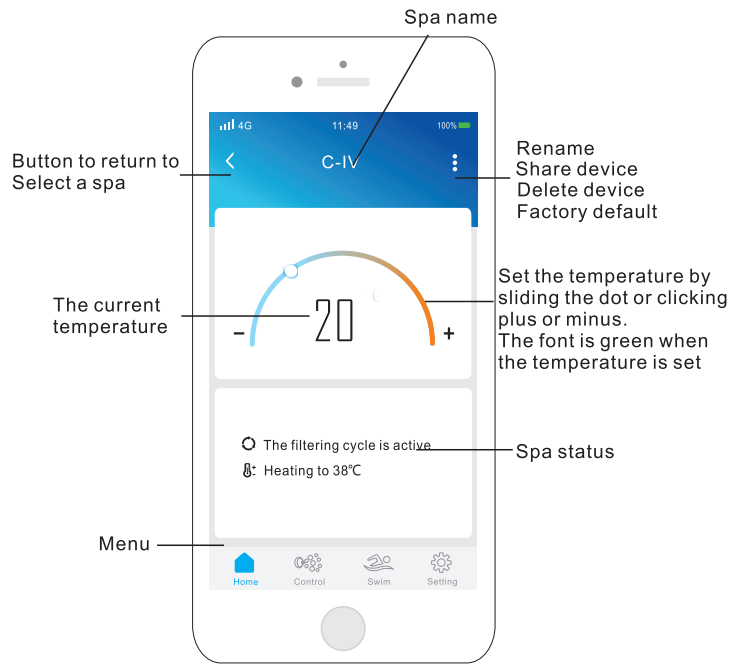

Swim page

In this page you can set the swimming mode, subscribe the swimming exercise health data. Only when your SPA has installed the swimming equipment, you can subscribe the data on the screen.

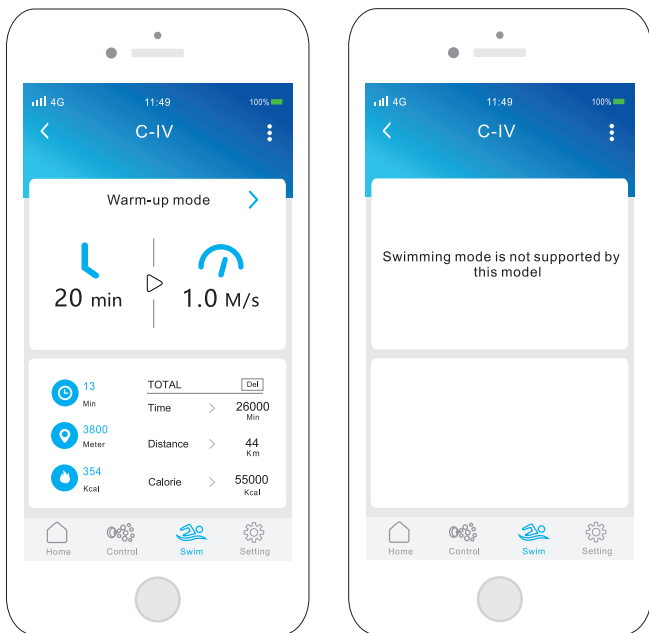

Swimming mode consists of warm-up mode, Sine wave mode, Skip mode, Surfing mode and Constant mode. Only when it is Constant mode, it can be set the speed and time.

Note: Swimming health data are for reference only.

Control page

In this page, you can control the massage pump, air pump (optional), light ON or OFF.

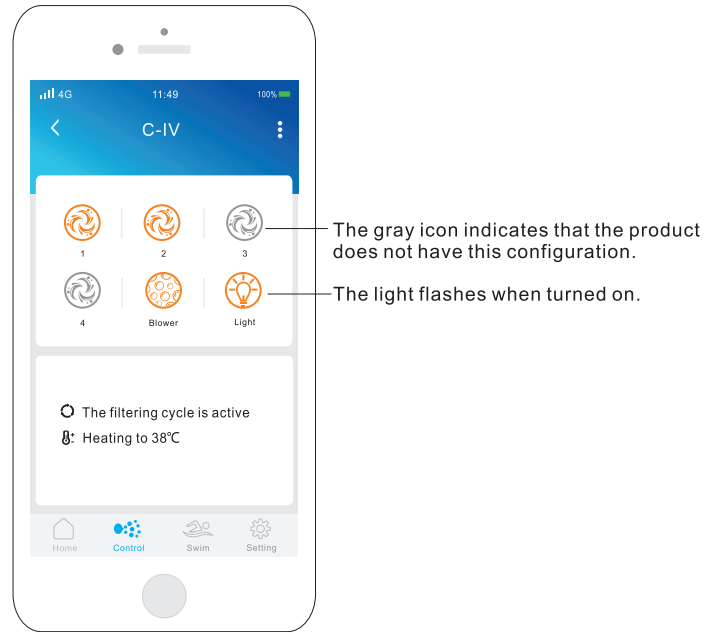

You can change the running time of the massage pump, but you need to set it in the control panel, not in this APP.

Setting page

In this page, you can set filter cycle, work mode, temperature unit, maintenance reminder and heat pump mode (optional).

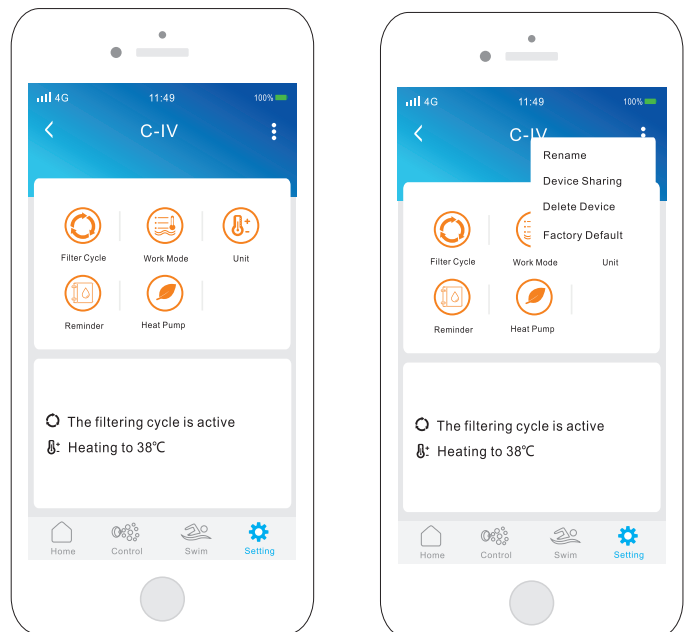

Filter Cycle

In this page, you can set the cycle of antivirus cycle.

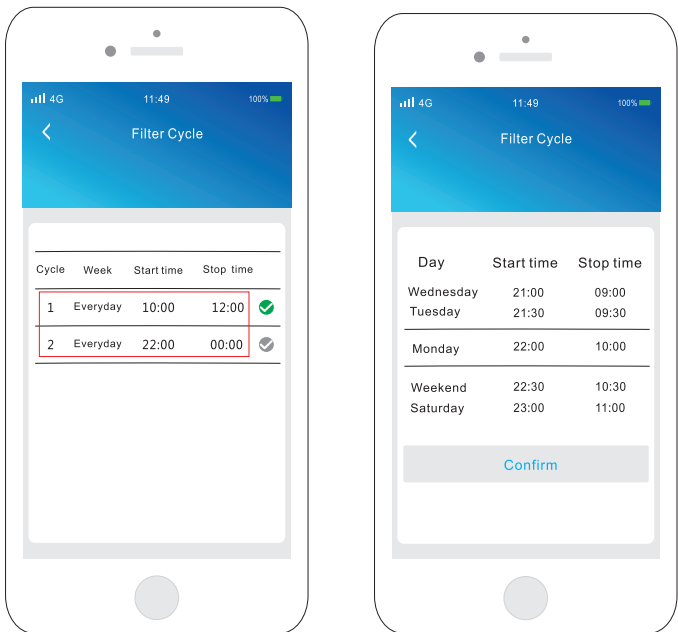

Click any position in the box to modify the antivirus cycle time. When you're done, click Confirm, The system automatically saves the Settings.

The green icon indicates that the system automatically starts in a cycle.

If the cycle is longer than 2 hours, ozone can only be activated for 2 hours at most. During the cycle of antivirus, starting the massage pump will make the antivirus equipment temporarily shut down for a period of time.

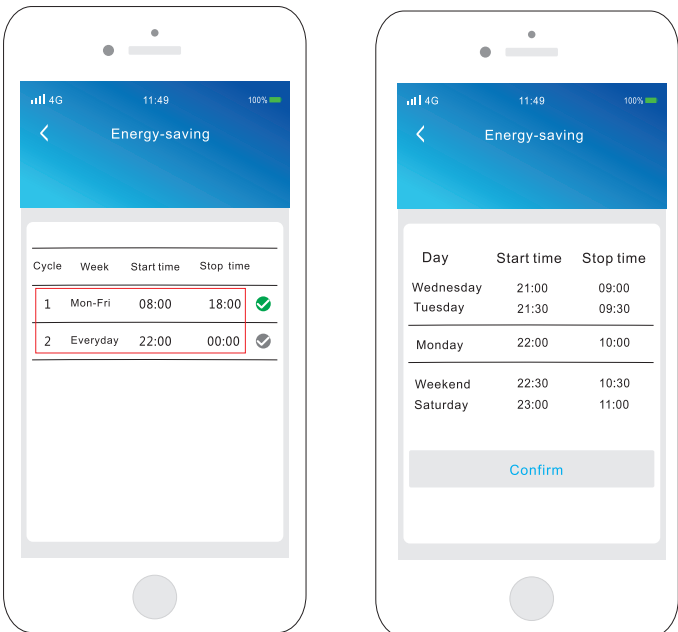

Touch the circle icon, a green checkmark will appear on the icon, indicating you have selected it. During the selected period and time, as long as the set temperature and current water temperature is less than or equal to 9°C, the system will not be heated or heated to within 9°C; During other times, as long as the set temperature is greater than the current water temperature, the system will immediately heat up.

Work Mode

The work mode page will help you set up your ideal heating settings. Choose from Standard mode, Energy-saving, Vacation mode and Sleep mode, depending on your need. Touch the work mode name you would like to activate, a green checkmark will appear on the icon, indicating what you have selected it.

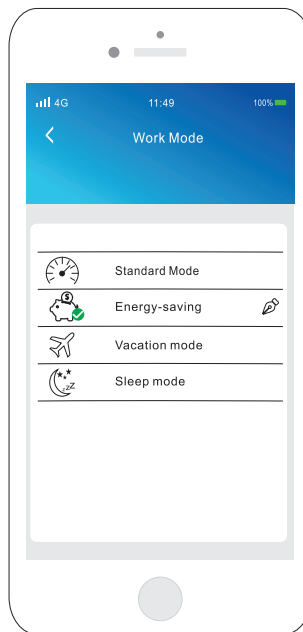

Standard Mode
As soon as the set temperature is higher than the current water temperature, the system will heat up immediately.

Energy-saving
From 8am to 6pm Monday to Friday, the system will not heat up if the set temperature is less than or equal to 9°C of the current water temperature.

Vacation mode
The system will not be heated every day if the set temperature is within 9°C of the current temperature.

Sleep mode
No matter what the set temperature is, the system will not heat up.

The time cycle setting method of each mode is the same as that of cyclic filter setting method.

Unit

The Unit page, depending on your need. Touch the Unit you would like to activate, a green checkmark will appear on the icon, indicating you have selected it.

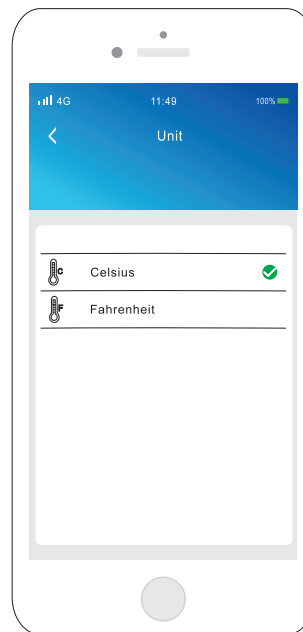

Reminder

The Reminder page will provide reminders about maintenance required on your spa, like rinsing or cleaning the filter. Every task has its own duration based on normal use.

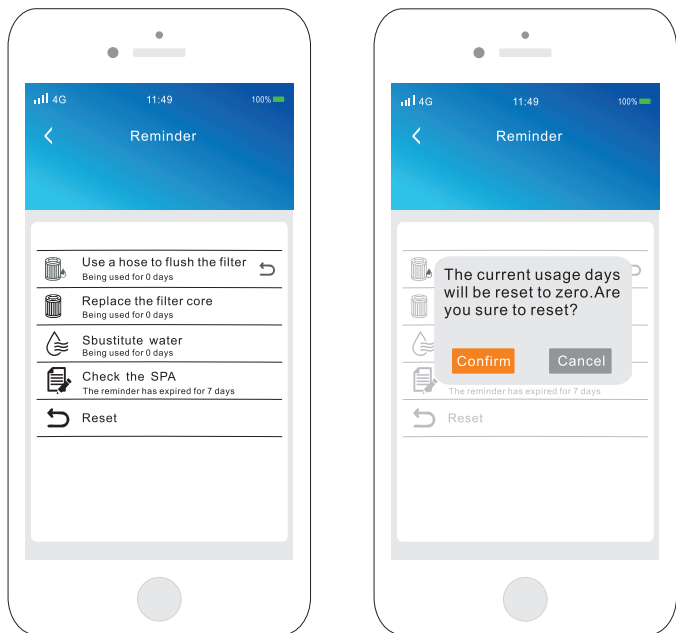

The Reminders menu allows you to check the time left before maintenance is required, as well as to reset the time once a task has been completed. To reset a task, select it by pressing the curved arrow, then confirm when prompted. Once you have confirmed, the task will be reset. You can also use the option Reset Reminders to reset all the reminders.

Troubleshoot

- Connection failure
 1. Check whether the power indicator is blinking at short intervals.
Please press the reset button for 5 seconds.
 2. Check that your phone is connected to a wireless network that can connect to the Internet.
 3. Make sure your phone, router and WiFi module are within 3 meters.
- Error code (Heat pump)

Please find a dealer for help.

 1. HP63-Water outlet temperature too low protection when defrosting.
 2. HP56-Water outlet too cold for cooling.
 3. HP01-System 1 exhaust temperature sensor failure.
 4. HP19-Water inlet temperature sensor failure.
 5. HP09-System 1 return gas temperature failure.
 6. HP22-Ambient temperature sensor failure.
 7. HP65-Ambient temperature too low protection.
 8. HP55-Water inlet/outlet temperature difference protection.
 9. HP51-System 1 exhaust temperature too high protection
 10. HP05-Coil temperature failure.
 11. HP18-Water outlet temperature sensor failure.
 12. HP42-System 1 high pressure protection.
 13. HP46-System 1 low pressure protection.
 14. HP41-Water flow protection.
 15. HP57-Antifreeze protection.
 16. HP99-Communication error.
- Error code (Control)
 - E9-Check filter,pump,blockage,air lock and water level
 - E1-Temperature sensor 1 open circuit or short circuit
 - E2-Temperature sensor 2 open circuit or short circuit
 - E0-Main panel communication failure
 - E5-Keep voltage or undervoltage
 - C-Low temperature protection
 - H-High temperature protection
 - HH-Abnormal ultra-high temperature protection

Heat pump

The Heat pump page, which gives you access to the following Heat pump modes:

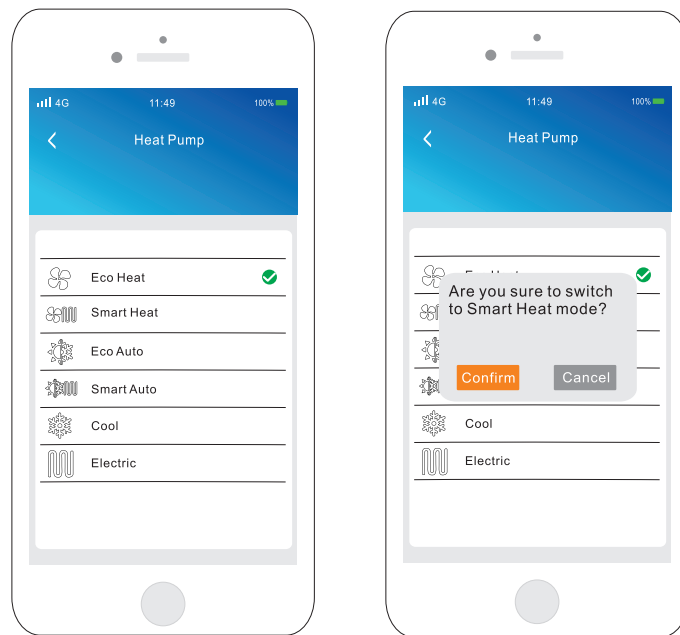

Slide to make a selection and Press on it to confirm. When you select a Heat Pump Mode, you will be asked to confirm your choice.

Choose between Eco Heat, Smart Heat, Eco Auto, Smart Auto, Cool and Electric, depending on your need. Touch the Heat Pump Mode name to choose your setting. A green checkmark will appear on the selected icon to confirm your choice.

When you select another Heat Pump Mode setting, a confirmation window appears to prevent inadvertent selection that could result in a setup modification for your spa.